

## BPT E H (heated) - Installation of ventilation flap

### 1 Components

The complete set consists of the parts holding tube, O-ring and ventilation flap.



### 2 Detents on holding tube

The holding tube has two diagonally arranged detents.



During subsequent installation, ensure that these detents are horizontal in the door.

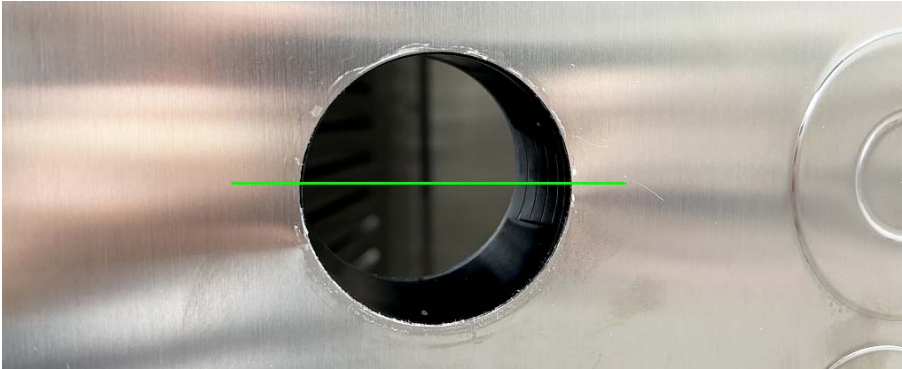

### 3 Preparation for assembly

In the area of the ventilation flap, remove any silicone adhesive residue from the inside and outside of the door as far as possible and then degrease thoroughly.

Roughen the inside of the holding tube and the outside of the ventilation flap slightly with 60 or 80 grit sandpaper.

On the holding tube, only the area (approx. 10-15 mm) into which the ventilation flap will later be inserted needs to be roughened.



Then thoroughly clean and degrease the inside of the holding tube and the outside of the ventilation flap.

### 4 Preparation of holding tube

Place the O-ring neatly all the way round in the groove in the collar of the holding tube.



Then apply a thin seam of silicone adhesive.  
Do not apply the adhesive to the O-ring, but between the O-ring and the tube.





Also apply a thin seam of silicone adhesive to the roughened surface on the inside of the holding tube.



In both cases, apply the silicone adhesive with restraint. Otherwise, the adhesive will ooze out when the parts are joined together in the door and cleaning work will be required - which is not necessary if done correctly.

**Remark for repairs:**

If the retaining tube is still securely seated in the door, it can still be used.

Then slightly roughen the inside of the holding tube from the outside, clean and degrease.

It may then not be possible to apply the silicone adhesive all the way round the inside. The following steps compensate for this disadvantage.

### 5 Installing/assembling parts

First insert the holding tube from the inside of the door.



Pay attention to the alignment of the detents.

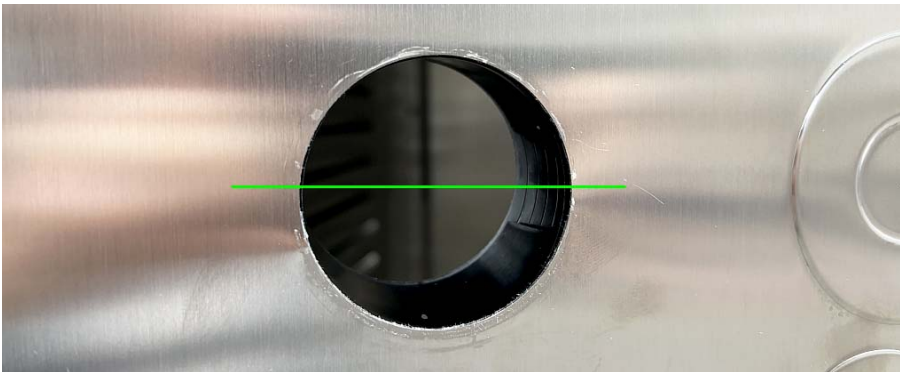

As a first step, position the ventilation flap only slightly.  
**Do not assemble the parts at this stage!**



Now reach into the open ventilation flap with the fingers of your right hand.  
Press firmly the holding tube with your left hand from the inside.

Use your right hand to turn the ventilation flap, which has **not yet been pressed in**, through 360° several times.

This distributes the silicone adhesive evenly between the holding tube and the ventilation flap.

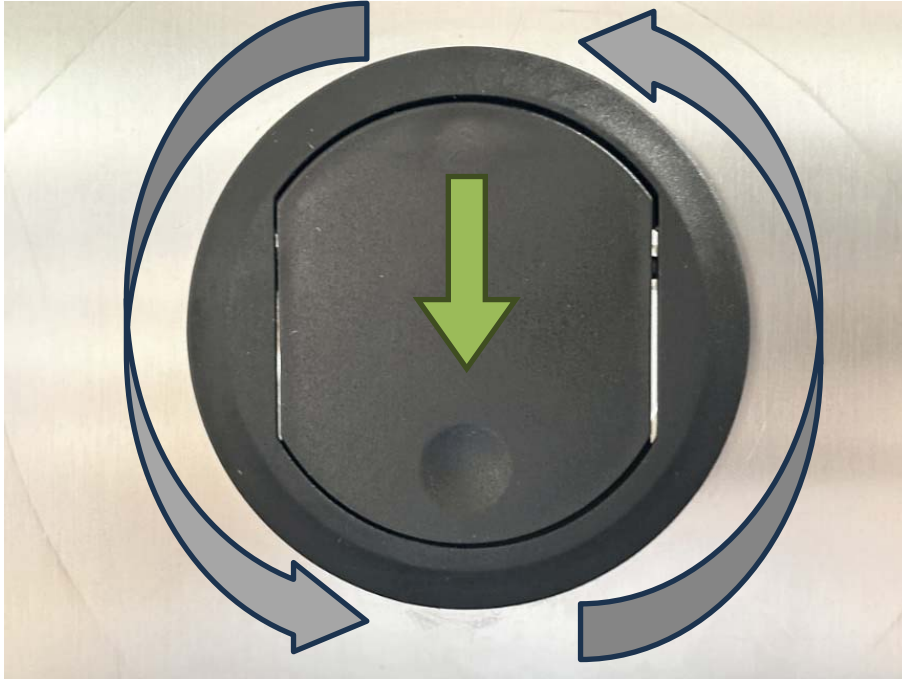

Position the ventilation flap so that the indentation for opening the flap - as shown in the picture above - shows **downwards**.

Only now press the ventilation flap fully into the holding tube.

Fully assembled ventilation flap from behind.





The adhesive should harden at room temperature and with the device door slightly open for at least six, preferably eight hours before the device is put back into operation.